



SU+PO/SU-PO

Spiral Pointed Taps for Stainless Steels
Specification



■ Suitable for stainless steels tending to work harden and sticky, as well as chrome steels and molybdenum steels. Through hole use.

SU+PO	~M2.6
SU-PO	M3~, all U, all W

Recommended Tapping Speeds depending on Materials

Low carbon steels 低炭素鋼	Medium carbon steels 中炭素鋼	Stainless steels ステンレス鋼
~10 (m/min)	~10 (m/min)	~10 (m/min)

For icon explanation, refer to P.24

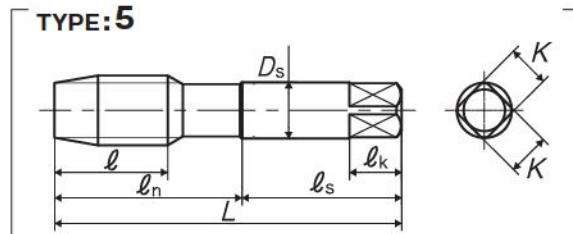
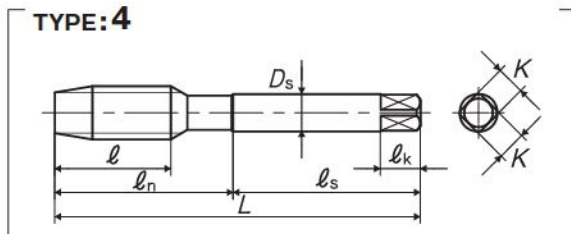
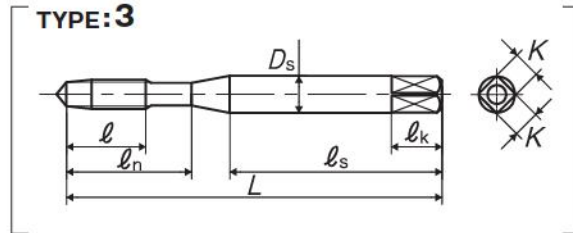
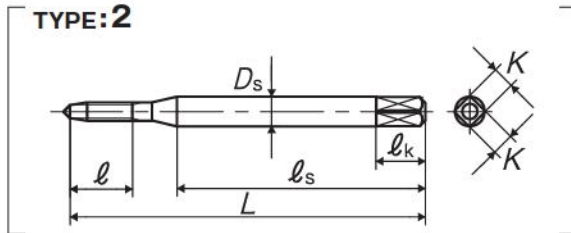
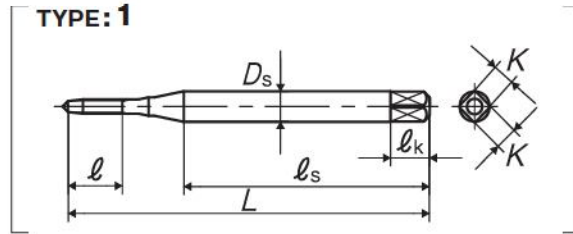

○ Oversize
Segment : 1E

Size	Class	Code	Chamfer	L (mm)	l (mm)	l _n (mm)	l _s (mm)	D _s (mm)	K (mm)	l _k (mm)	No. of flutes	Type	Stock
For Metric Threads													
M1.4 × 0.3	P1	PUPP1.4C	5P	36	5.4	-	24	3	2.5	5	2	1	△
M1.6 × 0.35	P2	PUPQ1.6D	5P	36	6.3	-	24	3	2.5	5	2	2	△
M1.7 × 0.35	P2	PUPQ1.7D	5P	36	6.3	-	24	3	2.5	5	2	2	△
M2 × 0.4	P2	PUPQ2.0E	5P	42	7.2	12	27	3	2.5	5	2	3	○
	P3	PUPR2.0E											△
M2.3 × 0.4	P2	PUPQ2.3E	5P	42	7.2	12	27	3	2.5	5	2	3	○
	P3	PUPR2.3E											△
M2.5 × 0.45	P2	PUPQ2.5F	5P	46	8.1	14	29	3	2.5	5	2	3	○
	P3	PUPR2.5F											△
M2.6 × 0.45	P2	PUPQ2.6F	5P	46	8.1	14	29	3	2.5	5	2	3	○
	P3	PUPR2.6F											△
M3 × 0.5	P2	PUMQ3.0G	5P	46	9	14	26	4	3.2	6	3	3	○
	P3	PUMR3.0G											△
	P4	PUMS3.0G											△
3M0.6	P2	PUMQ3.0H	5P	46	9	14	26	4	3.2	6	3	3	△

Overall length	Thread length	Thread+Neck length	Shank length	Shank dia.	Size of square	Length of square
L	ℓ	ℓn	ℓs	Ds	K	ℓk

SU+PO/SU-PO Spiral Pointed Taps for Stainless Steels

Size	Class	Code	Chamfer	L (mm)	ℓ (mm)	ℓn (mm)	ℓs (mm)	Ds (mm)	K (mm)	ℓk (mm)	No. of flutes	Type	Stock
M3.5 × 0.6	P2	PUMQ3.5H	5P	52	11	16	29	5	4	7	3	3	○
	P2	PUMQ4.0I											◎
M4 × 0.7	P3	PUMR4.0I	5P	52	11	17	29	5	4	7	3	3	△
	P4	PUMS4.0I											
4M0.75	P2	PUMQ4.0J	5P	52	11	17	29	5	4	7	3	3	△
M5 × 0.8	P2	PUMQ5.0K	5P	60	13	22	33	5.5	4.5	7	3	3	◎
	P3	PUMR5.0K											△
	P4	PUMS5.0K											
5M0.9	P2	PUMQ5.0L	5P	60	13	22	33	5.5	4.5	7	3	3	△
M6 × 1	P2	PUMQ6.0M	5P	62	15	26	33	6	4.5	7	3	3	◎
	P3	PUMR6.0M											△
	P4	PUMS6.0M											
M6 × 0.75	P2	PUMQ6.0J	5P	62	15	26	33	6	4.5	7	3	3	△
M7 × 1	P2	PUMQ7.0M	5P	70	19	-	36	6.2	5	8	3	4	△
M8 × 1.25	P3	PUMR8.0N	5P	70	19	-	36	6.2	5	8	3	4	◎
	P4	PUMS8.0N											△
	P5	PUMT8.0N											
M8 × 1	P3	PUMR8.0M	5P	70	19	-	36	6.2	5	8	3	4	○
M10 × 1.5	P3	PUMR0100	5P	75	23	-	38	7	5.5	8	3	4	◎
	P4	PUMS0100											△
M10 × 1.25	P3	PUMR010N	5P	75	23	-	38	7	5.5	8	3	4	○
	P4	PUMS010N											△
M10 × 1	P3	PUMR010M	5P	75	23	-	38	7	5.5	8	3	4	△
M12 × 1.75	P4	PUMS012P	5P	82	26	-	42	8.5	6.5	9	3	4	◎
	P5	PUMT012P											△
M12 × 1.5	P3	PUMR0120	5P	82	26	-	42	8.5	6.5	9	3	4	△
	P5	PUMT0120											
M12 × 1.25	P4	PUMS012N	5P	82	26	-	42	8.5	6.5	9	3	4	○
	P5	PUMT012N											△
M12 × 1	P3	PUMR012M	5P	82	26	-	42	8.5	6.5	9	3	4	△
M14 × 2	P4	PUMS014Q	5P	88	26	-	45	10.5	8	11	3	4	○
	P5	PUMT014Q											△
M14 × 1.5	P3	PUMR0140	5P	88	26	-	45	10.5	8	11	3	4	○
M16 × 2	P4	PUMS016Q	5P	95	26	-	48	12.5	10	13	3	4	○
	P5	PUMT016Q											△
	P6	PUMU016Q											
M16 × 1.5	P3	PUMR0160	5P	95	26	-	48	12.5	10	13	3	4	○
M16 × 1	P3	PUMR016M	5P	95	26	-	48	12.5	10	13	3	4	△
M18 × 2.5	P4	PUMS018R	5P	100	33	-	51	14	11	14	3	4	△
	P5	PUMT018R											
	P6	PUMU018R											
M18 × 1.5	P4	PUMS0180	5P	100	33	-	51	14	11	14	3	4	△
M20 × 2.5	P4	PUMS020R	5P	105	33	-	50	15	12	15	3	5	○
	P5	PUMT020R											△
	P6	PUMU020R											
M20 × 1.5	P4	PUMS0200	5P	105	33	-	50	15	12	15	3	5	△
M22 × 2.5	P4	PUMS022R	5P	115	33	-	55	17	13	16	3	5	△
	P5	PUMT022R											
	P6	PUMU022R											

Spiral Fluted Taps (for blind hole)
 Spiral Fluted Taps (for through hole)
 Spiral Pointed Taps (for through hole)
 Hand Taps
 Cemented Carbide Taps
 Roll Taps
 Special Thread Taps (Simple Inspection Tools)
 Pipe Taps
 Thread Mills
 Dies
 Center Drills
 Centering Tools